

entertainment table of contents

Entertainment	64	Cottage Collection.....	74
Shaker Collection.....	66	Traditional Collection.....	77
Hampshire Collection	68	Corner Cabinets.....	82
Fluted Collection	70	Pennsylvania Hardwood	84
Modern Collection	73	Media Bridges.....	88

Wood Letter Codes: maple: (m) oak: (k) cherry: (c)

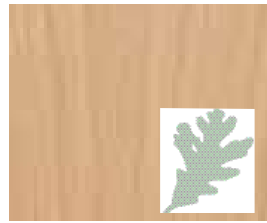

Drawers solid wood drawers feature English dovetail joints for lasting stability and are mounted on easy-rolling full extension ball bearing drawer glides.

Maple a light colored hardwood, Maple has a close, fine, uniform texture that is generally straight-grained. A very durable hardwood that will take any color stain or paint well.

Oak has a reddish cast and is a very hard wood with a mostly straight open grain. This is an extremely durable, great wear-resistance hardwood that accepts stains well to a beautiful finish.

Cherry a beautiful reddish brown to deep red color with lighter streaks of sapwood. Cherry has a fine uniform, straight grain, satiny, smooth texture, the beauty of this hard wood and accompanying even grain has been a favorite choice of furniture makers for centuries.

Woodcraft quality hardware options vary by style and collection. Your choices will be displayed on our collection pages.



Modern Chrome Pull MC



Brushed Nickel Cup Pull BN



Wood Knob W



Antique Brass Knob AB



Brushed Nickel Knob BN



Black Cup Pull BL



Antique Brass Cup Pull AB



Black Knob BL



Traditional Knob TD

Model Numbers

The model number at right reflects a maple, Charleston, one drawer night stand.

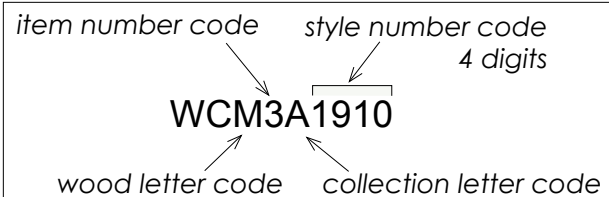

entertainment

Shaker

A traditional Pennsylvania Dutch design. Our best seller!

Hampshire

smooth curves create a beautiful contemporary beveled profile.

Modern

sleek and sophisticated "Urban" styling with a young vibe.

Fluted

handsome, solid styling showcases handcrafted elegant design.

Cottage

irresistably charming with unique beadboard styling.

Traditional

a classic style for years of quality performance.



Woodcraft entertainment furniture is built using premium grades of maple (m), oak (k) and cherry (c). The solid wood drawers feature dovetail joints and easy-rolling, ball bearing glides for lasting stability. Your choice of hardware styles on select collections.



The simplicity of the beautifully crafted Shaker Collection is timeless.



Component Tower
WC_3D1501

27 1/2"W X 50 1/4"H X 17"D
ONE FIXED SHELF
THREE ADJUSTABLE SHELVES

Woodcraft offers five semi-custom models from our line of Shaker entertainment furniture. Choose your favorite then order it in the perfect size to fit your particular space.



Full extension, ball-bearing drawer glide.



Wood Knob W



Note: 36" h and 30" h cabinets have 2 adjustable shelves, 24" h has 2 adjustable shelves, 30" h & 36" h have 6 drawers and 24" h has 4 drawers.

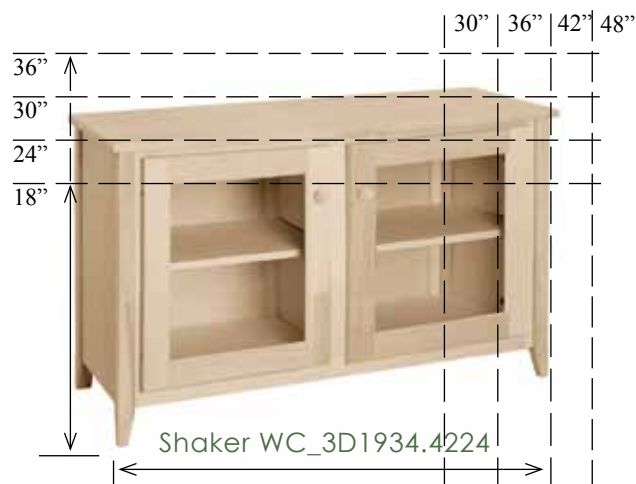

Note: 36" h and 30" h cabinets have 2 adjustable shelves per side, 24" h has 1 adjustable shelf per side and 18" h has no adjustable shelves. 42" & 48" wide have a center divider.

shaker

available in maple (**m**), oak (**k**) and cherry (**c**) wood.

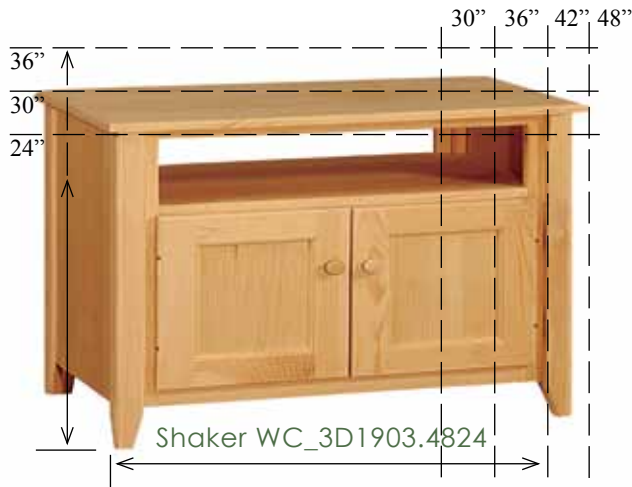

Note: 36\"h cabinets have 1 adjustable shelf, 30\"h and 24\"h have no adjustable shelves and 42\"w and 48\"w have a center divider.



Ordering Info:

to order semi-custom cabinets add the width then the height after the model number.

Example:

WC_3D1909.6630 is 66\"w x 30\"h

Example:

WC_3D1912.6030 is 60\"w x 30\"h

Example:

WC_3D1910.7230 is 72\"w x 30\"h



Note: for model 1909; 36\" and 30\" cabinets have 4 adjustable shelves, 24\" has 3 adjustable shelves and 18\" has no adjustable shelves.

- 18 inches is the standard depth for Shaker entertainment cabinets.
- Depth modification is available by request.
- The center width will be 20 inches.
- Square, flat panel doors and wood knobs are standard on all Shaker entertainment cabinets.
- Banded tops.
- Finishing is available in 14 stains, 9 paints and 3 specialty finishes.



Note: for models 1910; 36\" and 30\" cabinets have 4 adjustable shelves, 24\" has 3 adjustable shelves and 18\" has no adjustable shelves.



The smooth lines of our Hampshire Collection create an inviting style in your entertainment space. Available in maple (**m**) and oak (**k**) wood.



Note: for model 1912; 40" h and 34" h cabinets have 2 adjustable shelves.



Note: for model 1915; 40" h and 34" h cabinets have 2 adjustable shelves, 28" h has 1 adjustable shelf and 40" h and 34" h cabinets have 6 drawers 28" h has 4 drawers.



Note: for model 1914; 40" h and 34" h cabinets have 4 adjustable shelves.



Hardware Options



Antique Brass
Knob AB



Brushed Nickel
Knob BN



Wood
Knob W



Black
Knob BL



Full extension, ball-bearing
drawer glide.

Mitered doors are available on all Hampshire Entertainment. Add "**M**" after the style code letter. Example:

style letter code mitered door code

WC_3WM1934.3628

is 36" w x 28" h with mitered raised panel doors.

hampshire



Note: for model 1910; 40" h and 34" h cabinets have 4 adjustable shelves, 28" h has 3 adjustable shelves and 22" h has no adjustable shelves.



Ordering Info:

to order semi-custom cabinets add the width then the height after the model number.

Example:

WC_3W1934.3628 is 36" w x 28" h

Example:

WC_3W1910.6034 is 60" w x 34" h

Example:

WC_3W1909.6634 is 66" w x 34" h

- 17 inches is the standard depth for Hampshire entertainment cabinets.
- Depth modification is available by request.
- The center width will be 20 inches.
- Arched, raised panel doors are standard on all Hampshire entertainment cabinets.
- Banded tops.
- Finishing is available in 14 stains, 9 paints and 3 specialty finishes.



Note: for model 1934; 40" h and 34" h cabinets have 2 adjustable shelves per side, 28" h has 1 adjustable shelf per side and 22" h has no adjustable shelves. 42" w and 48" w have a center divider.



Note: for model 1909; 40" h and 34" h cabinets have 4 adjustable shelves, 28" h has 3 adjustable shelves and 22" h has no adjustable shelves.



fluted



available in maple (m) and oak (k) wood.



Note: for model 1912; 36" and 30" cabinets have 2 adjustable shelves.



Note: for model 1909; 36" and 30" cabinets have 4 adjustable shelves, 24" has 3 adjustable shelves and 18" has no adjustable shelves.



Note: for model 1914; 36" and 30" cabinets have 3 adjustable shelves.



Hardware Options



Antique Brass
Knob AB



Brushed Nickel
Knob BN



Wood
Knob W



Black
Knob BL



Hutch 3H0802 shown with TV cabinet 3H1914

Fluted Hutch

WC_3H0802

62"W X 48"H X 11 1/2"D
FIVE ADJUSTABLE SHELVES
34"W TV OPENING

www.woodcraftms.com



Our Fluted Collection makes it the choice for handsome furniture you will be glad to share.

fluted



Note: for model 1915; 36" h and 30" h cabinets have 2 adjustable shelves, 24" h has 1 adjustable shelf, 30" h & 36" h has 6 drawers and 24" h has 4 drawers.



Note: for model 1934; 36" h and 30" h cabinets have 2 adjustable shelves per side, 24" h has 1 adjustable shelf per side, 18" h has no shelves. 42" w & 48" w have a center stile.



Note: for model 1910; 36" and 30" cabinets have 4 adjustable shelves, 24" has 3 adjustable shelves and 18" has no adjustable shelves.



Ordering Info:

to order semi-custom cabinets add the width then the height after the model number.

Example:

WC_3H1934.3018 is 30" w x 18" h

Example:

WC_3H1910.7236 is 72" w x 36" h

Example:

WC_3H1915.5430 is 54" w x 30" h

- 17 inches is the standard depth for Fluted entertainment cabinets.
- Depth modification is available by request.
- The center width will be 20 inches.
- Raised panel doors and solid wood fluting are standard on Fluted entertainment cabinets.
- Banded tops.
- Finishing is available in 14 stains, 9 paints and 3 specialty finishes.



fluted



available in maple (m) and oak (k) wood.

The lasting quality of our Fluted Collection makes it the choice for handsome furniture you will personally enjoy for entertainment or professional spaces.



Bridge WC_3H1405

Tower WC_3H0807.FRHL

Tower WC_3H0807.FLHR

Base WC_3H1932.FR

Plasma TV Cabinet WC_3H1910.FS

Base WC_3H1932.FL

Bridges

WC_3H1405 **shown**

60"W X 12"H X 13 1/4"D

WC_3H1406

60"W X 18"H X 13 1/4"D

Component Tower

WC_3H0807

25 1/4"W X 48"H X 13 1/4"D

TWO ADJUSTABLE SHELVES
SPECIFY FLUSH LEFT OR FLUSH
RIGHT

WC_3H0808

25 1/4"W X 54"H X 13 1/4"D

THREE ADJUSTABLE SHELVES
SPECIFY FLUSH LEFT OR FLUSH
RIGHT

Two Drawer base

WC_3H1932 **shown**

25 1/4"W X 25"H X 17"D

SPECIFY FLUSH LEFT OR FLUSH
RIGHT

Plasma TV Cabinet

WC_3H1910.FS (25H)

60"W X 25"H X 17"D

THREE ADJUSTABLE SHELVES



Plasma TV Cabinet WC_3H1910

design center

Create a wall assembly that is functional and elegant with Fluted Design Center Entertainment pieces.

Hardware Options



Antique Brass
Knob AB



Brushed Nickel
Knob BN



Wood
Knob W



Black
Knob BL



This sleek, urban style features solid post construction.

available in maple (m) and oak (k) wood.

modern



Note: for model 1964; 36" h and 30" h cabinets have 2 adjustable shelves, per side 24" h has 1 adjustable shelf per side and 18" h has no adjustable shelves. 42" w & 48" w have a center divider.



Note: for model 1939; 36" h and 30" h cabinets have 4 adjustable shelves, 24" h has 3 adjustable shelves and 18" h has no adjustable shelves. The middle section is 20" wide.



Note: for model 1940; 36" h and 30" h cabinets have 4 adjustable shelves, 24" h has 3 adjustable shelves and 18" h has no adjustable shelves. The middle section is 20" wide.



Ordering Info:

to order semi-custom cabinets add the width then the height after the model number.

Example:

WC_3Z1964.4230 is 42" w x 30" h

Example:

WC_3Z1939.6630 is 66" w x 30" h

Example:

WC_3Z1940.6024 is 60" w x 24" h

- 16 inches is the standard depth for Modern entertainment cabinets.
- Depth modification is available by request.
- The center width will be 20 inches.
- Square, flat panel, mission doors and chrome pulls are standard on all Modern entertainment cabinets.
- Banded tops.
- Finishing is available in 14 stains, 9 paints and 3 specialty finishes.

Hardware Options



Modern Chrome Pull





Cottage Plasma TV Cabinet, WC_3E1915.FS; Component Towers, 62416MC.RMOD; 62416MC.LMOD.



Wood Knob W



Note: for model 1915; 40\"h & 34\"h cabinets have 2 adjustable shelves, 28\"h has 1 adjustable shelf, 34\"h & 40\"h have 6 drawers, 28\"h has 4 drawers.



Note: for model 1934; 36\"h and 30\"h cabinets have 2 adjustable shelves per side, 28\"h has 1 adjustable shelf per side and 22\"h has no adjustable shelves. 42\"w abd 48\"w have a center divider.



Authentic cottage styling, beautiful,
versatile, casual or formal, you choose.
available in maple (m) wood.

cottage



Ordering Info:

to order semi-custom cabinets add
the width then the height after the
model number.

Example:

WC_3E1934.3028 is 30" w x 128" h

Example:

WC_3E1909.5440 is 54" w x 40" h

Example:

WC_3E1910.6634 is 66" w x 34" h

- 17 inches is the standard depth for Cottage entertainment cabinets.
- Depth modification is available by request.
- The center width will be 20 inches.
- Beadboard panel doors, and wood knobs are standard on Cottage entertainment cabinets.
- Banded tops.
- Finishing is available in 14 stains, 9 paints and 3 specialty finishes.



Note: For model 1905 34" h & 40" h have 1 shelf, 28" h has no adjustable shelves and 42" w & 48" w have a center divider.



Note: for model 1909; 36" and 30" cabinets have 4 adjustable shelves, 28" has 3 adjustable shelves and 22" has no adjustable shelves.



cottage design center



available in maple (m) wood.

Our Cottage Design Center

collection lets you create a charming entertainment wall for your home or office.



Cottage Wall Assembly

Bridges

WC_3E1405 *shown*

58 3/8"W x 12"H x 13 1/4"D

WC_3E1406

58 3/8"W x 18"H x 13 1/4"D

Component Tower

WC_3E0807 *shown*

25"W x 48"H x 13 1/4"D

TWO ADJUSTABLE SHELVES

SPECIFY FLUSH LEFT OR FLUSH RIGHT

WC_3E0808

25"W x 54"H x 13 1/4"D

THREE ADJUSTABLE SHELVES

SPECIFY FLUSH LEFT OR FLUSH RIGHT

Two Drawer Base

WC_3E1932

24"W x 28"H x 17"D

SPECIFY FLUSH LEFT OR FLUSH RIGHT

Semi-Custom

Plasma TV Cabinet

WC_3E1910

58 1/2"W x 28"H x 17"D

THREE ADJUSTABLE SHELVES



Wood Knob W

Note: for model 1910; 36" and 30" cabinets have 4 adjustable shelves, 28" has 3 adjustable shelves and 22" has no adjustable shelves.



www.woodcraftms.com



available in maple (m) and oak (k) wood.

traditional

design center

Create a wall assembly that is functional and elegant with Traditional Design Center Entertainment pieces.



Traditional Wall Assembly

Bridges

WC_3A1405 *shown*

58 3/8"W X 12"H X 13 1/4"D

WC_3A1406

58 3/8"W X 18"H X 13 1/4"D

Component Towers

WC_3A0807 *shown*

25 1/4"W X 48"H X 13 1/4"D

TWO ADJUSTABLE SHELVES

SPECIFY FLUSH LEFT OR RIGHT

WC_3A0808

25 1/4"W X 54"H X 13 1/4"D

THREE ADJUSTABLE SHELVES

SPECIFY FLUSH LEFT OR RIGHT

Two Drawer Base

WC_3A1932 *shown*

24"W X 24"H X 17"D

SPECIFY FLUSH LEFT OR RIGHT

Plasma TV Cabinet

WC_3A1910

58 3/8"W X 24"H X 17"D

3 ADJUSTABLE SHELVES



Traditional Knob TD

Note: for model 1910; 36"h and 30"h cabinets have 4 adjustable shelves, 24"h has 3 adjustable shelves and 18"h has no adjustable shelves.



traditional



available in maple (**m**) and oak (**k**) wood.

Our Traditional Entertainment Collection will give you years of great performances.



Component Tower
SC_3A1502



Component Tower
SC_3A1503



Component Tower
SC_3A1501

Component Towers

SC_3A1501

25 1/2" w x 48" h x 17" d
four adjustable shelves

SC_3A1503

25 1/2" w x 60" h x 19" d
four adjustable shelves
specify hinge left or right when ordering

SC_3A1502

26 1/2" W X 72" H X 17 1/2" D
ONE FIXED SHELF
THREE ADJUSTABLE SHELVES
SPECIFY HINGE LEFT OR RIGHT WHEN ORDERING



Note: for model 1910; 36" h and 30" h cabinets have 4 adjustable shelves, 24" h has 3 adjustable shelves and 18" h has no adjustable shelves.



Traditional cabinet
with Mitered
door option.
WC_3AM1910.6618



Traditional Knob T



Traditional cabinet
with Mitered
door option.
WC_3AM1910.5436

Mitered doors are available on all Traditional Entertainment. Add "**M**" after the style code letter. Example:

style letter code mitered door code

WC_3AM1910.6624

is 66" w x 24" h with mitered raised panel doors.



available in maple (m) and oak (k) wood.

traditional



Traditional cabinet
with mitered door option
WC_3AM1934.4224

Mitered doors are available on all Traditional Entertainment. Add "M" after the style code letter.

Example:

style letter code

mitered door code

WC_3AM1934.4224

is 42" w x 24" h with mitered glass doors.



Traditional WC_3A1934.4224

Note: for model 1934; 36" h and 30" h cabinets have 2 adjustable shelves per side, 24" h has 1 adjustable shelf per side and 18" h has no adjustable shelves. 42" w & 48" w have a center divider.



Traditional WC_3A1901.4230

Note: cabinets have 1 adjustable shelf, 18" h has no adjustable shelf.



Traditional WC_3A1909.6024

Note: for model 1909; 36" h and 30" h cabinets have 4 adjustable shelves, 24" h has 3 adjustable shelves and 18" h has no adjustable shelves.



Traditional WC_3A1905.3630

Note: cabinets have 1 adjustable shelf, 24" h has no adjustable shelf.

traditional

available in maple (**m**) and oak (**k**) wood.



Mitered doors are available on all Traditional Entertainment. Add "**M**" after the style code letter.

Example:

style letter code mitered door code

WC_3AM1934.3018

is 30"w x 18"h with mitered doors.



Traditional Knob TD

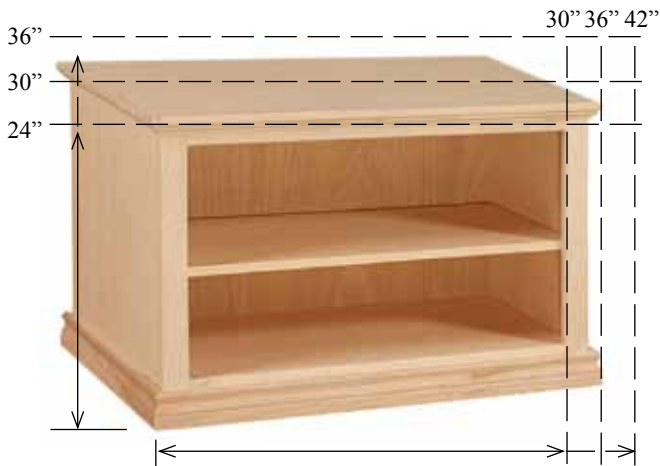

Traditional WC_3A1902.3624

Note: for model 1902; cabinets have one adjustable shelf. 36"h has 2 adjustable shelves.



Hutch WC_3A0804

73"W X 48"H X 11 1/4"D, TV OPENING 46" WIDE



Traditional cabinet 3A1912.7230 shown with Hutch 3A0804



Traditional WC_3A1912.6630

Note: for model 1912; 36"h and 30"h cabinets have 2 adjustable shelves.



traditional

available in maple (m) and oak (k) wood.



Traditional cabinet
with mitered door option
WC_3A1935.6630



Ordering Info:

to order semi-custom cabinets add the width then the height after the model number.

Example:

WC_3A1934.3018 is 30"w x 18"h

Example:

WC_3A1909.6024 is 60"w x 24"h

Example:

WC_3A1910.7230 is 72"w x 30"h

- 17 inches is the standard depth for Traditional entertainment cabinets.
- The center width will be 20 inches.
- Raised panel doors, and brass two-tone knobs are standard on Traditional entertainment cabinets.
- Banded tops.
- Finishing is available in 14 stains, 9 paints and 3 specialty finishes.
- Depth modification is available by request.
- Mitered doors are available.



corner cabinets

Semi custom corner cabinets are built and finished for you!



Traditional oak shown. See the chart on the opposite page for styles, model numbers, and wood species selections.



Fluted maple shown. See the chart on the opposite page for styles, model numbers, and wood species selections.

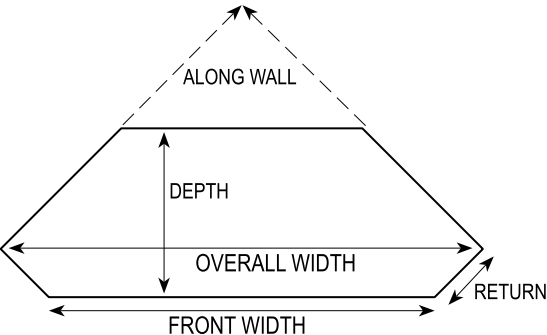

Options and features shown on these pages are for the corner plasma TV cabinets available in Traditional, Cottage and Fluted styles.

Ordering Info:

to order semi-custom cabinets add the width then the height after the model number.

Example:

WC_3H1121.6024 is 60" w x 24" h

- 16 inches is the standard depth for corner entertainment cabinets.
- Center opening is a minimum of 20" wide.
- Mitered doors are available on Traditional models.
- Banded tops.
- Can be modified in height only.
- Finishing is available in 14 stains, 9 paints and 3 specialty finishes.

Corner Plasma TV Stands

Front Width	Overall Width	Height	Depth	Return	Along Wall
48"	54"	18"	16"	4"	42"
48"	54"	24"	16"	4"	42"
48"	54"	30"	16"	4"	42"
48"	54"	36"	16"	4"	42"
54"	60"	18"	16"	4"	45"
54"	60"	24"	16"	4"	45"
54"	60"	30"	16"	4"	45"
54"	60"	36"	16"	4"	45"
60"	66"	18"	16"	4"	48"
60"	66"	24"	16"	4"	48"
60"	66"	30"	16"	4"	48"
60"	66"	36"	16"	4"	48"

Dimensions in this chart do not include trim.

corner cabinets

Choose from Traditional, Cottage and Fluted styles in
our unique corner entertainment cabinets.

Style Codes

A = Traditional



E = Cottage



maple only

H = Fluted



Wood Codes

M = Maple



K = Oak



available in:

maple (**m**) and oak (**k**) wood.

available in maple (**m**) only for Cottage style.

ITEM NO.	DIMENSIONS
Traditional	
WC_3A1120.5418	54"W x 18"H x 16"D
WC_3A1120.5424	54"W x 24"H x 16"D
WC_3A1120.5430	54"W x 30"H x 16"D
WC_3A1120.5436	54"W x 40"H x 16"D
WC_3A1120.6018	60"W x 18"H x 16"D
WC_3A1120.6024	60"W x 24"H x 16"D
WC_3A1120.6030	60"W x 30"H x 16"D
WC_3A1120.6036	60"W x 40"H x 16"D
WC_3A1120.6618	66"W x 18"H x 16"D
WC_3A1120.6624	66"W x 24"H x 16"D
WC_3A1120.6630	66"W x 30"H x 16"D
WC_3A1120.6636	66"W x 40"H x 16"D
WC_3A1121.5418	54"W x 18"H x 16"D
WC_3A1121.5424	54"W x 24"H x 16"D
WC_3A1121.5430	54"W x 30"H x 16"D
WC_3A1121.5436	54"W x 40"H x 16"D
WC_3A1121.6018	60"W x 18"H x 16"D
WC_3A1121.6024	60"W x 24"H x 16"D
WC_3A1121.6030	60"W x 30"H x 16"D
WC_3A1121.6036	60"W x 40"H x 16"D
WC_3A1121.6618	66"W x 18"H x 16"D
WC_3A1121.6624	66"W x 24"H x 16"D
WC_3A1121.6630	66"W x 30"H x 16"D
WC_3A1121.6636	66"W x 40"H x 16"D

ITEM NO.	DIMENSIONS
Cottage	
WC_3E1120.5418	54"W x 22"H x 16"D
WC_3E1120.5424	54"W x 28"H x 16"D
WC_3E1120.5430	54"W x 34"H x 16"D
WC_3E1120.5436	54"W x 40"H x 16"D
WC_3E1120.6018	60"W x 22"H x 16"D
WC_3E1120.6024	60"W x 28"H x 16"D
WC_3E1120.6030	60"W x 34"H x 16"D
WC_3E1120.6036	60"W x 40"H x 16"D
WC_3E1120.6618	66"W x 22"H x 16"D
WC_3E1120.6624	66"W x 28"H x 16"D
WC_3E1120.6630	66"W x 34"H x 16"D
WC_3E1120.6636	66"W x 40"H x 16"D
WC_3E1121.5418	54"W x 22"H x 16"D
WC_3E1121.5424	54"W x 28"H x 16"D
WC_3E1121.5430	54"W x 34"H x 16"D
WC_3E1121.5436	54"W x 40"H x 16"D
WC_3E1121.6018	60"W x 22"H x 16"D
WC_3E1121.6024	60"W x 28"H x 16"D
WC_3E1121.6030	60"W x 34"H x 16"D
WC_3E1121.6036	60"W x 40"H x 16"D
WC_3E1121.6618	66"W x 22"H x 16"D
WC_3E1121.6624	66"W x 28"H x 16"D
WC_3E1121.6630	66"W x 34"H x 16"D
WC_3E1121.6636	66"W x 40"H x 16"D

ITEM NO.	DIMENSIONS
Fluted	
WC_3H1120.5418	54"W x 18"H x 16"D
WC_3H1120.5424	54"W x 24"H x 16"D
WC_3H1120.5430	54"W x 30"H x 16"D
WC_3H1120.5436	54"W x 40"H x 16"D
WC_3H1120.6018	60"W x 18"H x 16"D
WC_3H1120.6024	60"W x 24"H x 16"D
WC_3H1120.6030	60"W x 30"H x 16"D
WC_3H1120.6036	60"W x 40"H x 16"D
WC_3H1120.6618	66"W x 18"H x 16"D
WC_3H1120.6624	66"W x 24"H x 16"D
WC_3H1120.6630	66"W x 30"H x 16"D
WC_3H1120.6636	66"W x 40"H x 16"D
WC_3H1121.5418	54"W x 18"H x 16"D
WC_3H1121.5424	54"W x 24"H x 16"D
WC_3H1121.5430	54"W x 30"H x 16"D
WC_3H1121.5436	54"W x 40"H x 16"D
WC_3H1121.6018	60"W x 18"H x 16"D
WC_3H1121.6024	60"W x 24"H x 16"D
WC_3H1121.6030	60"W x 30"H x 16"D
WC_3H1121.6036	60"W x 40"H x 16"D
WC_3H1121.6618	66"W x 18"H x 16"D
WC_3H1121.6624	66"W x 24"H x 16"D
WC_3H1121.6630	66"W x 30"H x 16"D
WC_3H1121.6636	66"W x 40"H x 16"D

entertainment



Two Door Stand
B30101



One Drawer Stand
B30102

Keystone Collection

Pennsylvania Hardwood Keystone Entertainment

Two Door Stand

B30101

29 1/2"W X 26"H X 17"D
2 RAISED PANEL DOORS

One Drawer Stand

B30102

29 1/2"W X 26"H X 17"D
1 DRAWER
FULL EXTENSION DRAWER GLIDE

Tall Stand

B30103

43"W X 30"H X 17"D
2 ADJUSTABLE SHELVES

Tall Two Door Stand

B30104

43"W X 30"H X 17"D
2 RAISED PANEL DOORS
2 ADJUSTABLE SHELVES

Wide Two Drawer Stand

B30105

43"W X 26"H X 17"D
2 DRAWERS
FULL EXTENSION DRAWER GLIDES

Note: No Modifications.



Wood Knob W



FSC CERTIFIED
PENNSYLVANIA HARDWOOD

Basswood is creamy white in color, with pale to redish brown heartwood, sometimes with darker streaks, a fine, uniform texture and straight grain.



Full extension, ball-bearing
drawer glide.



Dove Tail, Solid Wood, Drawer Box



available in basswood

pennsylvania hardwood

Responsibly harvested, hand crafted, solid wood furniture from the heart of Pennsylvania.



Tall Stand
B30103



Keystone Top Detail



Keystone Base Moulding



Tall Two Door Stand
B30104



Wide Two Drawer Stand
B30105

entertainment

Allegheny COLLECTION

TV Stands

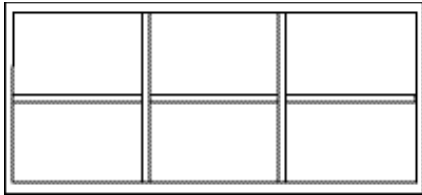

LWK6030FND
LWK6030FND

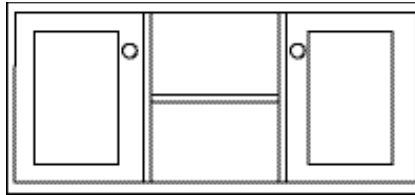

LWK6030F2D
LWK6030C2D

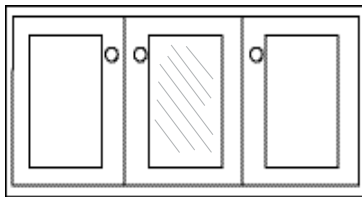

LWK5430F3D
LWK5430C3D

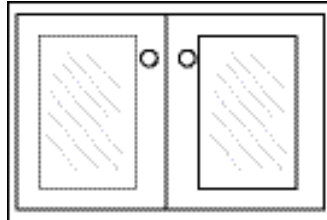

LWK4830F2D
LWK4830C2D

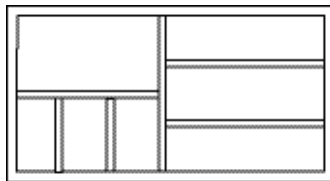

LWK4830FND
LWK4830CND

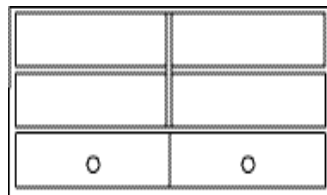

LWK4830F2DW
LWK4830C2DW

Towers

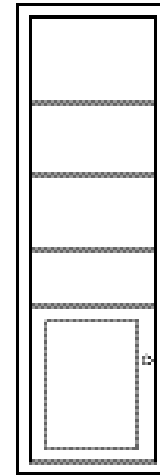

LWK2472FBD
LWK2472CBD

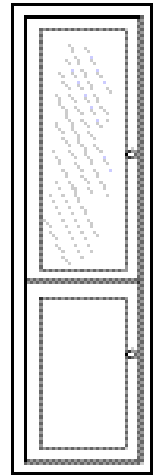

LWK2472FTBD
LWK2472CTBD

Bridges

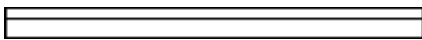

LWK6002FBR
LWK7202FBR
LWK6002CBR
LWK7202CBR

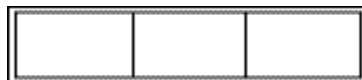

LWK5418FBR
LWK6018FBR
LWK5418CBR
LWK6018CBR



LWK4818FBR
LWK4818CBR

Note: No Modifications.



Wood Knob W



FSC CERTIFIED
PENNSYLVANIA HARDWOOD

Oak a very hard wood with a mostly straight open grain, extremely durable, great wear-resistance hardwood that accepts stains well.



Full extension, ball-bearing drawer glide.



Dove Tail, Solid Wood, Drawer Box



available in oak wood.

pennsylvania hardwood

Responsibly harvested, hand crafted, solid wood furniture from the heart of Pennsylvania.



Contemporary
Entertainment Cabinet
LWK6030C3D



Shaker Entertainment
Cabinet
LWK6030F2D

contemporary

Note: No Modifications.

Model #	Description	Dimensions	Model #	Description	Dimensions
TV Stands			Towers		
LWK6030CND	TV Stand - No Doors	60"w x 30"h x 16"d	LWK2472CBD	Tower - Bottom Door 3 adjustable shelves	24"w x 72"h x 16"d
LWK6030C2D	TV Stand - 2 Doors	60"w x 30"h x 16"d	LWK2472CTBD	Tower - Top & Bottom Door 3 adjustable shelves	24"w x 72"h x 16"d
LWK5430C3D	TV Stand - 3 Doors	54"w x 30"h x 16"d	Bridges		
LWK6030C3D	TV Stand - 3 Doors	60"w x 30"h x 16"d	LWK4818CBR	Hanging Bridge	48"w x 18"h x 16"d
LWK4830CND	TV Stand - No Doors 3 Shelves & 2 Dividers	48"w x 30"h x 16"d	LWK5418CBR	Hanging Bridge	54"w x 18"h x 16"d
LWK4830C2D	TV Stand - 2 Doors	48"w x 30"h x 16"d	LWK6018CBR	Hanging Bridge	60"w x 18"h x 16"d
LWK4830C2DW	TV Stand - 2 Dwrs	48"w x 30"h x 16"d	LWK6002CBR	Floating Bridge	60"w x 02"h x 16"d
			LWK7202CBR	Floating Bridge	72"w x 02"h x 16"d

shaker

Model #	Dimensions	Dimensions	Model #	Description	Dimensions
TV Stands			Towers		
LWK6030FND	TV Stand - No Doors	60"w x 30"h x 16"d	LWK2472FBD	Tower - Bottom Door 3 adjustable shelves	24"w x 72"h x 16"d
LWK6030F2D	TV Stand - 2 Doors	60"w x 30"h x 16"d	LWK2472FTBD	Tower - Top & Bottom Door 3 adjustable shelves	24"w x 72"h x 16"d
LWK5430F3D	TV Stand - 3 Doors	54"w x 30"h x 16"d	Bridges		
LWK6030F3D	TV Stand - 3 Doors	60"w x 30"h x 16"d	LWK4818FBR	Hanging Bridge	48"w x 18"h x 16"d
LWK4830FND	TV Stand - No Doors 3 Shelves & 2 Dividers	48"w x 30"h x 16"d	LWK5418FBR	Hanging Bridge	54"w x 18"h x 16"d
LWK4830F2D	TV Stand - 2 Doors	48"w x 30"h x 16"d	LWK6018FBR	Hanging Bridge	60"w x 18"h x 16"d
LWK4830F2DW	TV Stand - 2 Dwrs	48"w x 30"h x 16"d	LWK6002FBR	Floating Bridge	60"w x 02"h x 16"d
			LWK7202FBR	Floating Bridge	72"w x 02"h x 16"d

media bridges



available in maple (**m**), oak (**k**) and cherry (**c**) wood.

Media bridges for dressers and chests

easy access to your TV and componants in any room

ITEM NO.	DIMENSIONS
Traditional maple and oak wood	
WC_3A1420.18	18"w x 12"d
WC_3A1420.24	24"w x 12"d
WC_3A1420.30	30"w x 12"d
WC_3A1420.36	36"w x 12"d
WC_3A1420.42	42"w x 12"d
WC_3A1420.48	48"w x 12"d
WC_3A1421.18	18"w x 16"d
WC_3A1421.24	24"w x 16"d
WC_3A1421.30	30"w x 16"d
WC_3A1421.36	36"w x 16"d
WC_3A1421.42	42"w x 16"d
WC_3A1421.48	48"w x 16"d
Shaker maple, oak and cherry wood	
WC_3D1420.18	18"w x 12"d
WC_3D1420.24	24"w x 12"d
WC_3D1420.30	30"w x 12"d
WC_3D1420.36	36"w x 12"d
WC_3D1420.42	42"w x 12"d
WC_3D1420.48	48"w x 12"d
WC_3D1421.18	18"w x 16"d
WC_3D1421.24	24"w x 16"d
WC_3D1421.30	30"w x 16"d
WC_3D1421.36	36"w x 16"d
WC_3D1421.42	42"w x 16"d
WC_3D1421.48	48"w x 16"d
Cottage maple wood	
WC_3E1420.18	18"w x 12"d
WC_3E1420.24	24"w x 12"d
WC_3E1420.30	30"w x 12"d
WC_3E1420.36	36"w x 12"d
WC_3E1420.42	42"w x 12"d
WC_3E1420.48	48"w x 12"d
WC_3E1421.18	18"w x 16"d
WC_3E1421.24	24"w x 16"d
WC_3E1421.30	30"w x 16"d
WC_3E1421.36	36"w x 16"d
WC_3E1421.42	42"w x 16"d
WC_3E1421.48	48"w x 16"d
WC_3H1420.18	18"w x 12"d

ITEM NO.	DIMENSIONS
Fluted maple and oak wood	
WC_3H1420.24	24"w x 12"d
WC_3H1420.30	30"w x 12"d
WC_3H1420.36	36"w x 12"d
WC_3H1420.42	42"w x 12"d
WC_3H1420.48	48"w x 12"d
WC_3H1421.18	18"w x 16"d
WC_3H1421.24	24"w x 16"d
WC_3H1421.30	30"w x 16"d
WC_3H1421.36	36"w x 16"d
WC_3H1421.42	42"w x 16"d
WC_3H1421.48	48"w x 16"d
Hampshire maple and oak wood	
WC_3W1420.18	18"w x 12"d
WC_3W1420.24	24"w x 12"d
WC_3W1420.30	30"w x 12"d
WC_3W1420.36	36"w x 12"d
WC_3W1420.42	42"w x 12"d
WC_3W1420.48	48"w x 12"d
WC_3W1421.18	18"w x 16"d
WC_3W1421.24	24"w x 16"d
WC_3W1421.30	30"w x 16"d
WC_3W1421.36	36"w x 16"d
WC_3W1421.42	42"w x 16"d
WC_3W1421.48	48"w x 16"d



Traditional WCK3A1420.42
shown in oak



Fluted WCM3H3016
shown in maple

Media Bridge
for Dressers and Chests

Media Bridge 12"

WC_3A1420

7 1/2"H X 12"D

COMPONENT OPENING IS 5"H

AVAILABLE IN THE FOLLOWING WIDTHS:

18", 24", 30", 36", 42", 48"

Media Bridge 16"

WC_3A1421

7 1/2"H X 16"D

COMPONENT OPENING IS 5"H

AVAILABLE IN THE FOLLOWING WIDTHS:

18", 24", 30", 36", 42", 48"

Style Codes

A = Traditional

D = Shaker

E = Cottage

H = Fluted

W = Hampshire