



# design center

Choose components (pages 122 & 123), options (page 121) and door and trim styles (pages 124 & 125) on the **design center** pages for your special furniture piece or wall system.

**Create Something Spectacular!**

## Available Wood Species



MAPLE



OAK



## Drawer Box



Drawer Joint

Drawer boxes are constructed of 1/2" solid wood and have four English dovetail corners. With 1/4" plywood drawer bottoms.

## Hardware



Concealed Hinge

Doors feature a 1/2" overlay, fully concealed, six-way adjustable hinge.

## Drawer Glides



Ball Bearing Glide

Full extension, ball bearing drawer glides are standard on Design Center furniture.

## Other Options



Adjustable wine and stemware shelves for minimum 24" width and 14" depth. (.WS)



Pullout trays available for inside door openings a minimum of 8 1/2" wide and 12" deep. (.PO)

## Knob Options



Brushed Nickel BN



Antique Brass AB



Black BL



Traditional TD



Wood W

## Bookcases (B):

Standard widths: 12", 18", 24", 30", 36", 42", 48", 60"

Standard depths: 12", 16", 20", 24"

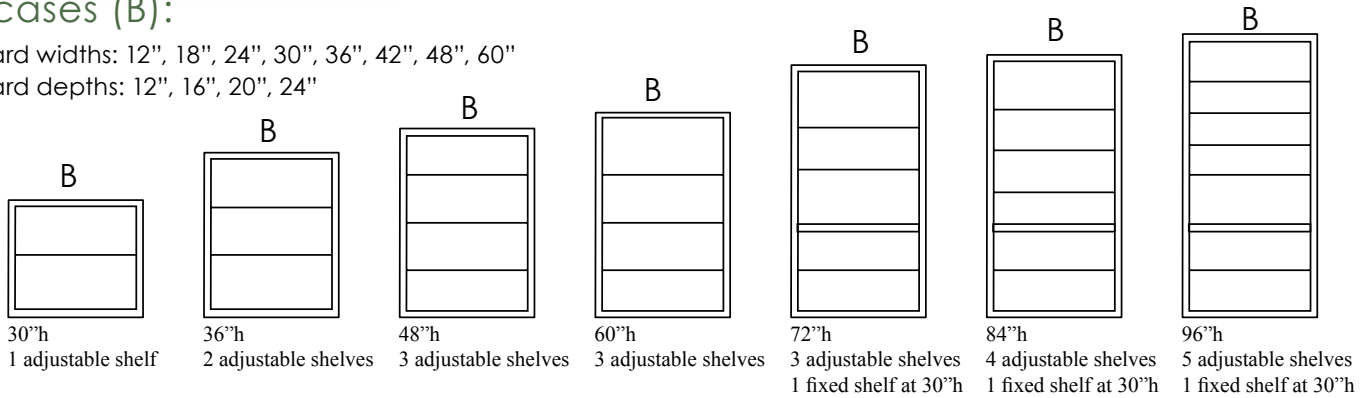

### CODE KEY

- B** Bookcase
- H** Hutch
- BD** Bookcase with doors
- BDD** bookcase with upper & lower doors
- BDW** Bookcase with drawers
- BDWD** Bookcase with doors and drawers
- C** Corner bookcase
- T** TV stand
- R** Bridges
- D** Base drawer cabinet

**NOTE:** All bookcases, bases and hutches less than 24" have one door.

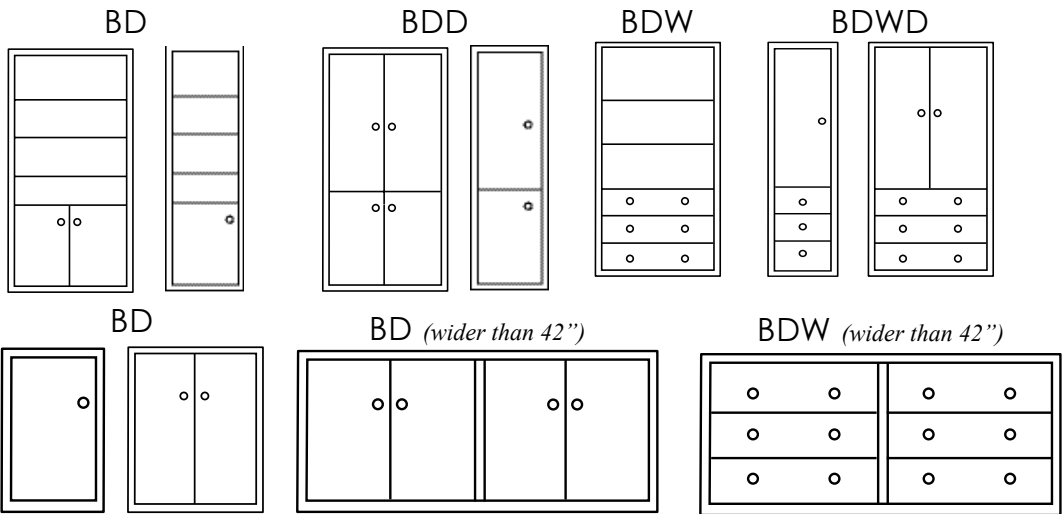

**NOTE:** All bookcases and hutches wider than 42" have a center divider and double doors or drawers.

Specify hinge right (**HR**) or hinge left (**HL**) on units with one door.

## Corner Bookcases (C): Standard heights: 30", 36", 48", 60", 72", 84", 96"

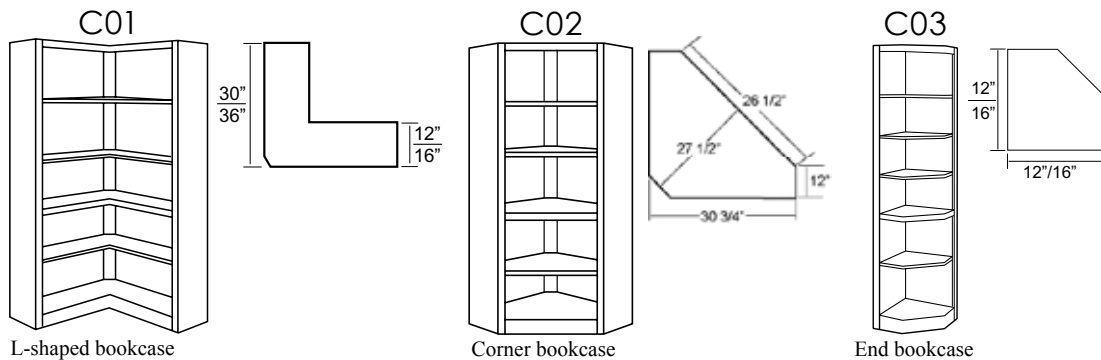

### NOTE:

Our wall system units are pre-assembled at our factory using adjustable hex bolts which provide easy on-site installation.



**NOTE:** Corner bookcases can be modified in height only. 6'h, 7'h, 8'h, corner bookcases have a fixed shelf at 30".

## Base Cabinets (D): Standard heights: 24", 30", 36"; Standard widths: 18", 24", 30", 36";

Standard depths: 12", 16", 20", 24" **NOTE:** D01 Bases less than 24"w have one door.

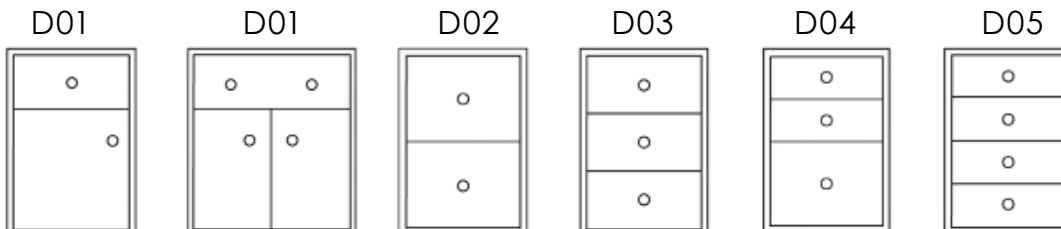



# design center

	Product Code	Width	Height	Depth	Top Moulding	Base Moulding	Top Configuration	Base Configuration	Back	Drawer Hardware	Knob
<b>SAMPLE:</b>	BDWD	36"	72"	12"	02	02	02	01	01	.FE	AB

## Hutches (H) and Hutches with Doors (HD): Standard widths: 12", 18", 24", 30", 36", 42", 48", 60"

Standard depths: 12", 16", 20", 24"

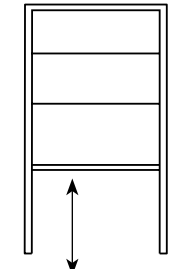
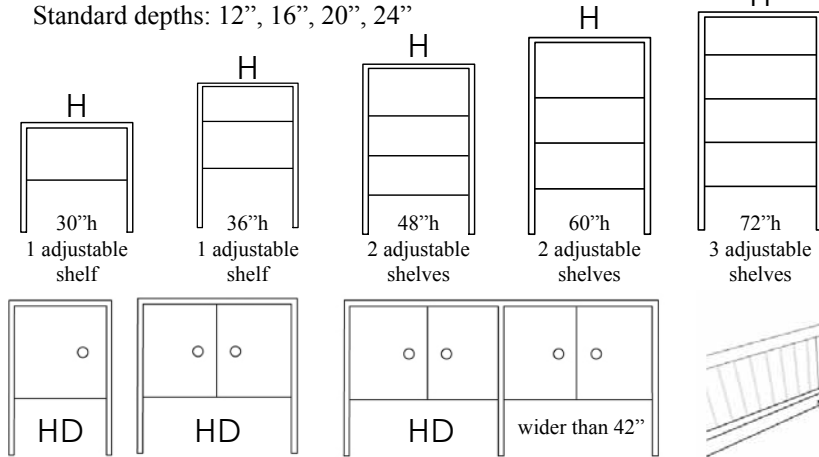

**NOTE:** Specify the fixed shelf location when ordering.

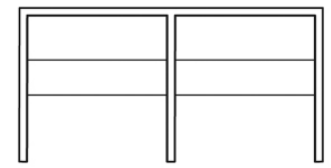

**NOTE:** All bookcases, bases and hutches less than 24" have one door or drawer. All bookcases and hutches wider than 42" have a center divider and double doors or drawers. Specify hinge right (HR) or hinge left (HL) on units with one door.

All hutches include stabilizing mounting blocks.

## Bridges (R): Standard heights: 18", 21", 24"; Standard depths: 12", 16", 20", 24"; specify the crown moulding.

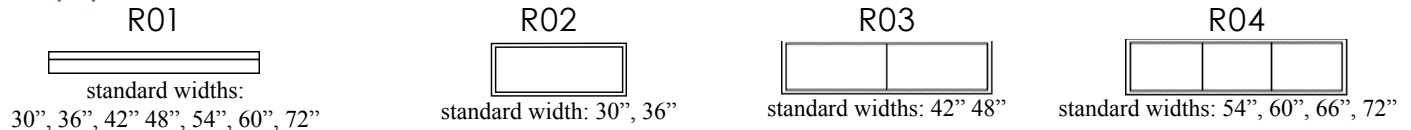

## Desk Assembly (D):

**DA** standard widths with one drawer: 18", 21", 24", 30"; with two drawers: 36", 42"; height: 8 1/4"; depth: 16", 20", 24"; **DP** keyboard pullout, **DS** desk side support and **DT** desk top are optional.

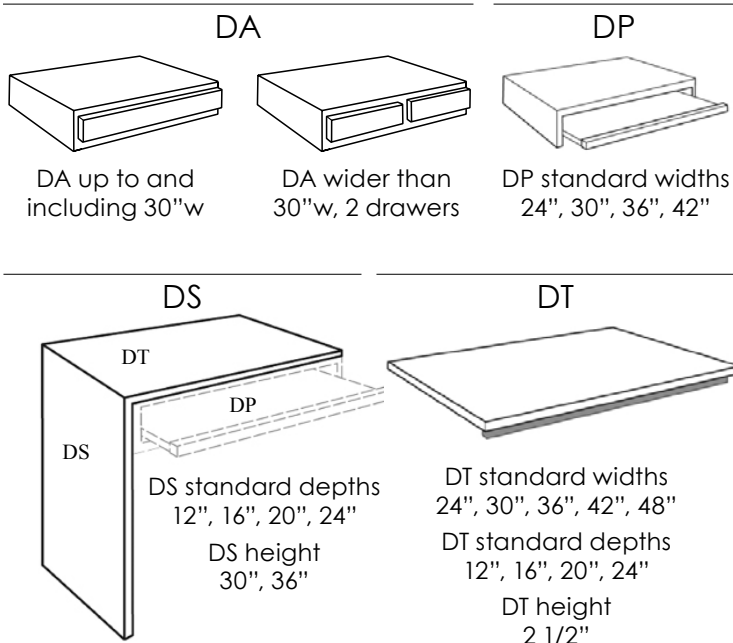

## Entertainment Cabinets (T):

Standard widths for T01 and T02: 30", 36", 42", 48"  
T01 and T02 cabinets wider than 42" have a center divider and double doors.

Standard widths for T03, T04, T05, and T06: 54", 60", 66", 72"

Standard heights: 18", 24", 30", 36", 42"

Standard depths: 16", 20", 24"

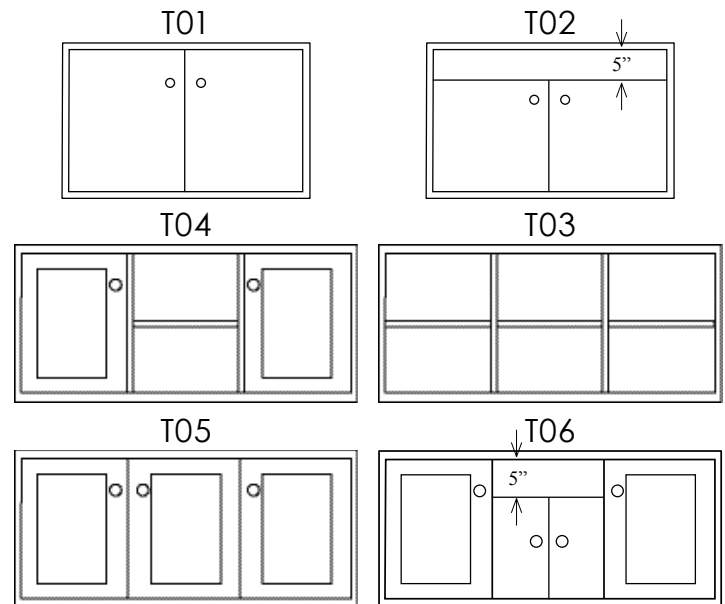

**NOTE:** Center opening width is 20"w.



## Choose a moulding style or cases without moulding

crown moulding



CROWN 01



cove moulding



COVE 01



base moulding



BASE 01



CROWN 02

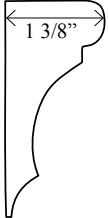

COVE 02

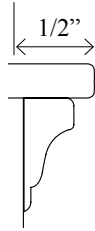

BASE 03

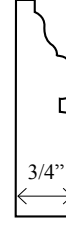

**NOTE:** Case dimensions do not include moulding size.  
Order mouldings in 8 foot lengths if you prefer to trim out the cases yourself.

## Furniture Backs

The standard backs of each piece of furniture is 1/4" plywood. You can choose an optional beadboard back.



01 standard back



02 beadboard back  
maple only

## Specify top and base moulding configurations

flush base

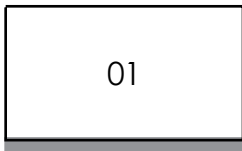

01 Top or base moulding is flush on both sides.

top flush crown

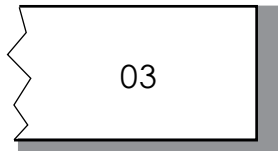

03 Top or base moulding is flush on the right or left side.

top flush cove



04 Top or base moulding has an overlap on the left or right side.

full wrap

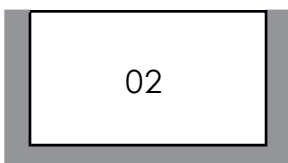

02 Top or base moulding fully wraps all three sides.

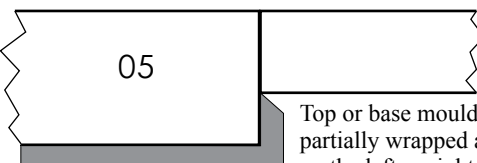

Top or base moulding is partially wrapped and mitered on the left or right side.

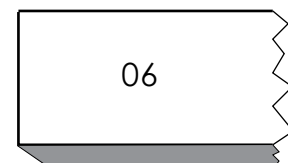

06 moulding is mitered on the left or right side.

**NOTE:** Base moulding can be ordered flush or wrapped independent of the top moulding.



# door styles



available in maple (**m**) and oak (**k**) wood.

Choose a door from the design center options on this page.

## Door Styles

**NOTE:** Mullions cannot be applied to mitered or mission doors.



Winthrop  
Flat Panel



Lynfield  
Raised Panel



Dartmouth  
Beadboard  
maple only



Rockport  
Mitered Flat Panel



Bellingham  
Mitered Raised Panel



Cameron  
Mission

## Glass Door Styles



Glass



Glass Mullions



Glass Mitered



Glass Mission

**Premium Design Center** offers all the quality and options of Design Center in our most popular styles: **Cottage, Hampshire, Fluted & Vintage** shown on page 126. Build your piece without the guess work.



# premium design center



cottage



vintage



**cottage**  
beadboard panels and doors, solid wood turned feet. crown 02, cove 01.



**vintage**  
flat panels and doors, deluxe base moulding, crown 01, cove 02.



fluted



hampshire



**fluted** solid wood fluting, raised panel doors, and deluxe base moulding, crown 02, cove 02.



**hampshire**  
curved skirt, arched, raised panel doors, solid wood feet, modern crown, cove 02

# top mouldings



**CROWN 01**  
2 3/4"H X 1 3/8"TH STANDARD ON:  
Vintage and  
Traditional Collections

6', 7' & 8' top  
crown moulding 01



**CROWN 02**  
2 3/4"H X 1 3/8"TH STANDARD ON:  
Cottage and Fluted

6', 7' & 8' top deluxe  
crown moulding 02



top cove moulding 01   top cove moulding 02

**COVE 01** 3/4"H X 1/2"TH STANDARD ON:  
Cottage, Country, and Traditional Collections

**COVE 02** 1"H X 1/2"TH STANDARD ON:  
Hampshire, Fluted, Vintage Collections



# base mouldings



Base 01

---

Base 01 2 7/8"H X 3/4"TH STANDARD ON:  
Traditional Collection



base moulding 01



Base 03

---

Base 03 3 3/4"H X 3/4"TH STANDARD ON:  
Fluted, and Vintage.



base moulding 03



Base 05

---

Base 05 3 1/2"H X 3/4"TH STANDARD ON:  
Country Living & Dining



base moulding 05



HALF ROUND 01

---

HALF ROUND 01  
1/2"H X 1/4"TH



HALF ROUND 02

---

HALF ROUND 02  
3/4"H X 3/8"TH